

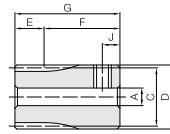

Specifications	
Precision grade	JIS grade N8 (JIS B1702-1:1998)
Gear teeth	Standard full depth
Pressure angle	20°
Material	S45C
Heat treatment	—
Tooth hardness	(less than 194HB)
Surface treatment	Black oxide coating

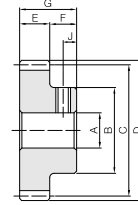

S3T



S1T

* The precision grade of products with a module of less than 0.8 is equivalent to the value shown in the table.

Catalog Number	Module	No. of teeth	Shape	Bore	Hub dia.	Pitch dia.	Outside dia.	Face width	Hub width	Total length	Keyway Width × Depth
				A _{H7/h8}	B	C	D	E	F	G	
SS0.5-15A	m0.5	15	S3T	3 _{H8}	8.5	7.5	8.5	5	11	16	—
SS0.5-18A		18		4 _{H8}	10	9	10				
SS0.5-20A		20		3 _{H8}	11	10	11				
SS0.5-20B				4 _{H8}	11	10	11				
SS0.5-22A		22		4 _{H8}	12	11	12				
SS0.5-24A		24		4 _{H8}	13	12	13				
SS0.5-24B			5 _{H8}	13	12	13					
SS0.5-25B		25	5 _{H8}	13.5	12.5	13.5					
SS0.5-28A		28	4 _{H8}	12	14	15					
SS0.5-30B		30	5	13	15	16					
SS0.5-50B		50	6	22	25	26					
SS0.5-54A		54	5	25	27	28					
SS0.5-60A	60	S1T	6	28	30	31					
SS0.5-80A			6	28	40	41					
SS0.5-80B	8	8	28	48	49						
SS0.5-96A	96	8	28	60	61						
SS0.5-120A	120	8	28	60	61						
SS0.8-15A	m0.8	15	S3T	5 _{H8}	13.6	12	13.6	8	8	16	—
SS0.8-20A		20	5 _{H8}	13	16	17.6					
SS0.8-20B			6	16	17.6						
SS0.8-25A		25	5 _{H8}	16	20	21.6					
SS0.8-28A		28	6	18	22.4	24					
SS0.8-30A			5 _{H8}	20	24	25.6					
SS0.8-30C		8	6	28	32	33.6					
SS0.8-40A		40	6	28	32	33.6					
SS0.8-45A		45	6	28	36	37.6					

- [Caution on Product Characteristics]
- The key groove used is a JIS B 1301 normal type (Js9) and a set screw is included for products with a tapped hole.
 - The allowable torques shown in the table are calculated values according to the assumed usage conditions. Please see Page 38 for more details.
 - The backlash values shown in the table are the theoretical values for the backlash in the normal direction of a pair of identical gears in mesh.
 - When using S3T and S1T set screws for fastening gears to a shaft, only use this method for applications with light load usage. For secure fastening, please use dowel pins in combination.

Socket head screw	Size	J	Allowable torque (N·m)		Allowable torque (kgf·m)		Backlash (mm)	Weight (kg)	Catalog Number
			Bending strength	Surface durability	Bending strength	Surface durability			
M3	2.5	M3	0.46	0.022	0.047	0.0022	0~0.10	0.0056	SS0.5-15A
M3			0.61	0.032	0.063	0.0033		0.0076	SS0.5-18A
M3	2.5	M3	0.72	0.040	0.073	0.0041		0.010	SS0.5-20A
M3			0.83	0.049	0.084	0.0050		0.0095	SS0.5-20B
M3	3	M4	0.93	0.059	0.095	0.0060		0.012	SS0.5-22A
M4			0.99	0.064	0.10	0.0065		0.014	SS0.5-24A
M3	3	M4	1.16	0.081	0.12	0.0082		0.013	SS0.5-24B
M4			1.27	0.093	0.13	0.0095		0.014	SS0.5-25B
M4	3.5	M4	2.43	0.27	0.25	0.027		0.011	SS0.5-28A
M4			2.67	0.32	0.27	0.032		0.012	SS0.5-30B
M4	3.5	M4	3.03	0.39	0.31	0.040		0.037	SS0.5-50B
M4			4.24	0.72	0.43	0.074		0.047	SS0.5-54A
M5	3.5	M5	5.21	1.06	0.53	0.11	0.058	SS0.5-60A	
M5			6.68	1.70	0.68	0.17	0.079	SS0.5-80A	
M4	3.5	M4	1.89	0.088	0.19	0.0090	0.077	SS0.5-80B	
M4			2.94	0.17	0.30	0.017	0.099	SS0.5-96A	
M4	4	M4	4.05	0.27	0.41	0.027	0.14	SS0.5-120A	
M4			4.73	0.34	0.48	0.035	0.019	SS0.8-15A	
M4	4	M4	5.19	0.39	0.53	0.040	0.018	SS0.8-20A	
M5			7.55	0.72	0.77	0.074	0.017	SS0.8-20B	
M4	4	M4	8.75	0.93	0.89	0.095	0.029	SS0.8-25A	
M4			8.75	0.93	0.89	0.095	0.037	SS0.8-28A	
M4	4	M4	8.75	0.93	0.89	0.095	0.045	SS0.8-30A	
M4			8.75	0.93	0.89	0.095	0.041	SS0.8-30C	
M4	4	M4	8.75	0.93	0.89	0.095	0.085	SS0.8-40A	
M4			8.75	0.93	0.89	0.095	0.098	SS0.8-45A	

- [Caution on Secondary Operations]
- Please read "Cautions on Performing Secondary Operations" (Page 40) when performing modifications and/or secondary operations for safety concerns. KHK Quick-Mod Gears, the KHK system for quick modification of KHK stock gears, is also available.
 - Avoid performing secondary operations that narrow the tooth width, as it affects precision and strength.